



# KAI TAK PROMENADE AND LANDSCAPE DECK NEAR METRO PARK

TASK FORCE PAPER ON KAI TAK HARBOURFRONT DEVELOPMENT

AUGUST 2022



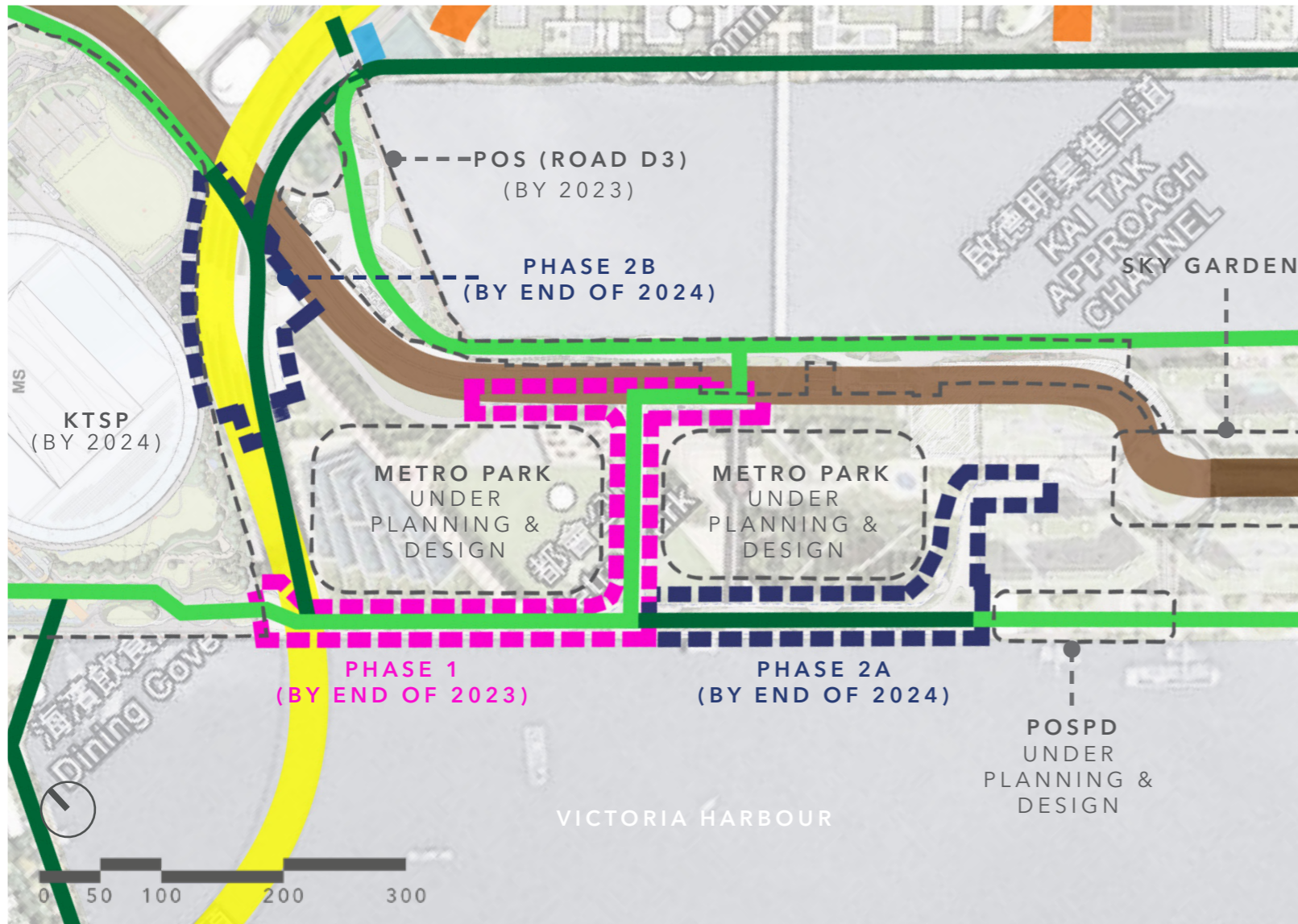

SITE LOCATED AT TREE TRUNK PORTION OF KAI TAK DNA BAR

## 2. CONCEPT

### TREE TRUNK AS A SYMBOL OF HARMONY AND LIVELINESS

1. RESPONSE TO THE **URBAN/WATERFRONT** SETTING

2. REFERENCE TO KAI TAK PROMENADE **DESIGN GUIDELINES** DNA BAR

3. **COHERENCE AND HARMONY** WITH ADJACENT DEVELOPMENT (E.G. KTSP, POSPD & BASECAMP BEING CONSTRUCTED BY CEDD)

4. GREENWAY PROVIDES **DIFFERENT VIEWS AND CONNECTS** WITH ANCILLARY FUNCTIONS

5. EXCITING ENVIRONMENT FOR PUBLIC ENJOYMENT

### GREEN WAY ARRANGEMENT



- LONG MONOTONOUS WALKWAY
- NO VIEWS



- LONG MONOTONOUS WALKWAY
- VIEW OF VICTORIA HARBOUR FOR CIRCULATION
- NO VIEWS FOR PROGRAMS



- VARIETY OF DIFFERENT VIEWS AND EXPERIENCES
- UPLIFTING AND EXCITING
- OPENS UP TO BOTH VICTORIA HARBOUR & FUTURE METRO PARK





### 3. CIRCULATION AND PROGRAM EFFICIENCY & OPTIMIZATION OF SPATIAL PLANNING

1. ARRANGEMENT OF **ACTIVE** AND **PASSIVE** ACTIVITIES RESPOND TO SITE CONTEXT
2. 3 FORMS OF CIRCULATION WITH DIFFERENT **EXPERIENCES**
3. ANCILLARY FACILITIES ARE REFERENCED FROM THE **GREENWAY GUIDELINES**

# 4. MASTER LAYOUT PLAN

## FORM, PROPORTION & SCALE



PHASE 2B



PHASE 1



PHASE 2A

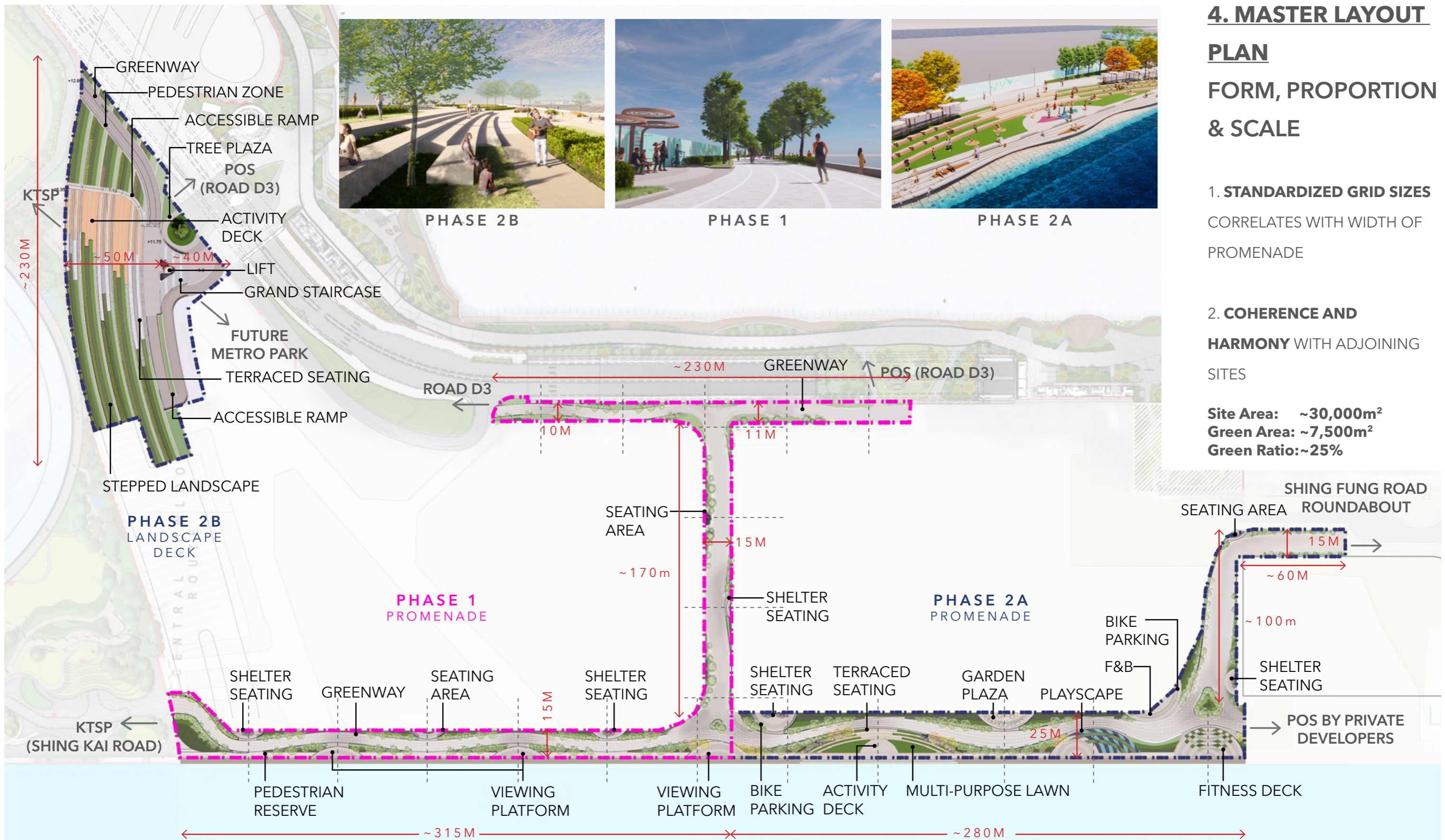

1. **STANDARDIZED GRID SIZES**  
CORRELATES WITH WIDTH OF PROMENADE

2. **COHERENCE AND HARMONY** WITH ADJOINING SITES

Site Area: ~30,000m<sup>2</sup>  
Green Area: ~7,500m<sup>2</sup>  
Green Ratio: ~25%



1:2000 PLAN

**4. MASTER LAYOUT  
PLAN  
AERIAL  
PERSPECTIVE**

**VISUAL COHERENCE,  
INTERACTION AND  
HARMONY WITH  
ADJOINING SITES**



EAST COAST PARK

Victoria Harbour  
signage applied  
to Multi-purpose  
Event Space

# 4. MASTER LAYOUT PLAN

## CONNECTIVITY OF PROMENADE



- PROJECT SITE
- ↔ PROPOSED GREENWAY OF 6M WIDTH WITHIN PROJECT SITE
- ↔ PROPOSED GREENWAY OF 8M WIDTH WITHIN PROJECT SITE
- GREENWAY MIN. 2M WIDTH
- PEDESTRIAN ZONE
- - - POSSIBLE PEDESTRIAN CONNECTION

ROUNDBABOUT  
ROAD D3



1:2000 PLAN

# 4. MASTER LAYOUT PLAN

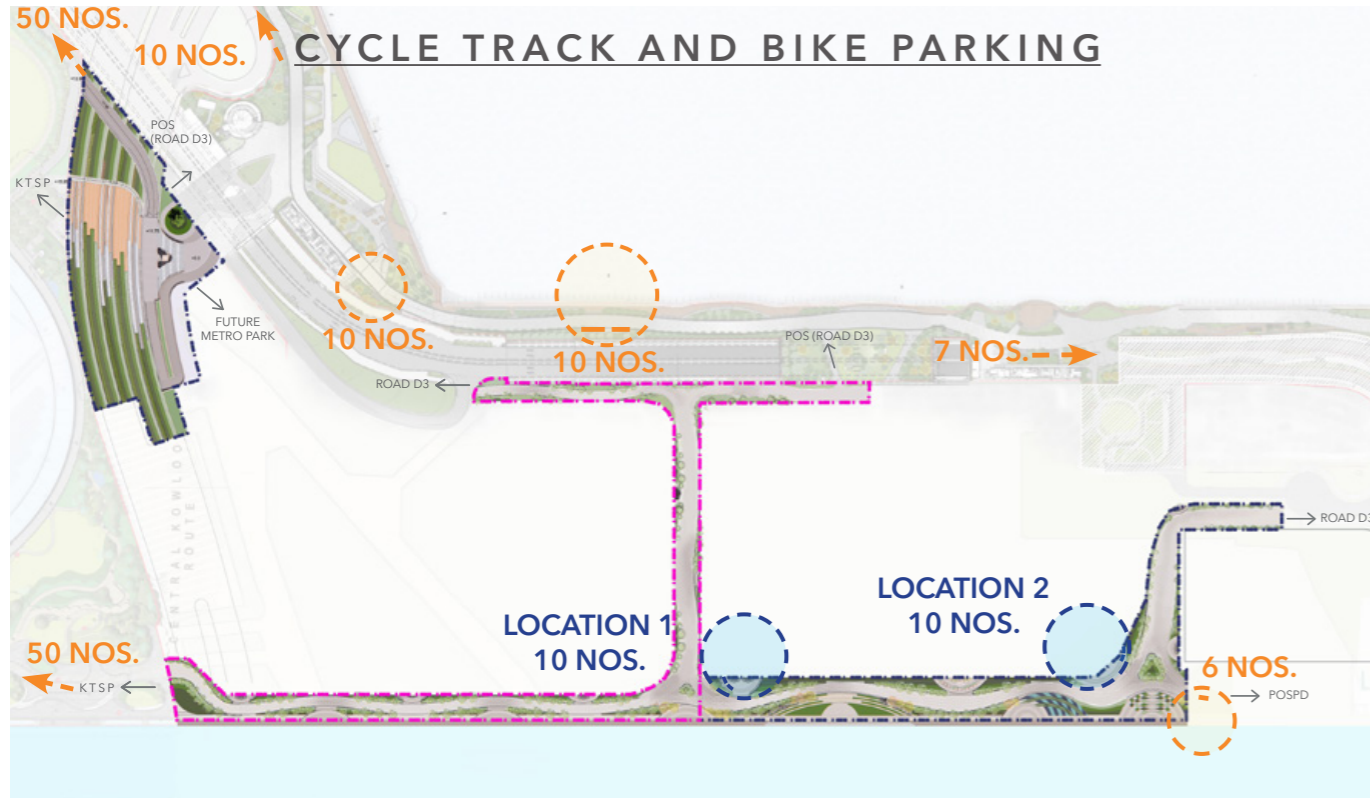

█ BIKE PARKING LOCATIONS TOTAL: 20 NOS.  
█ BIKE PARKING LOCATIONS IN ADJACENT POS (Subject to confirmation from relevant parties)  
 POS(ROAD D3): 37 NOS.  
 POSPD: 6 NOS.  
 KTSP: 100 NOS.

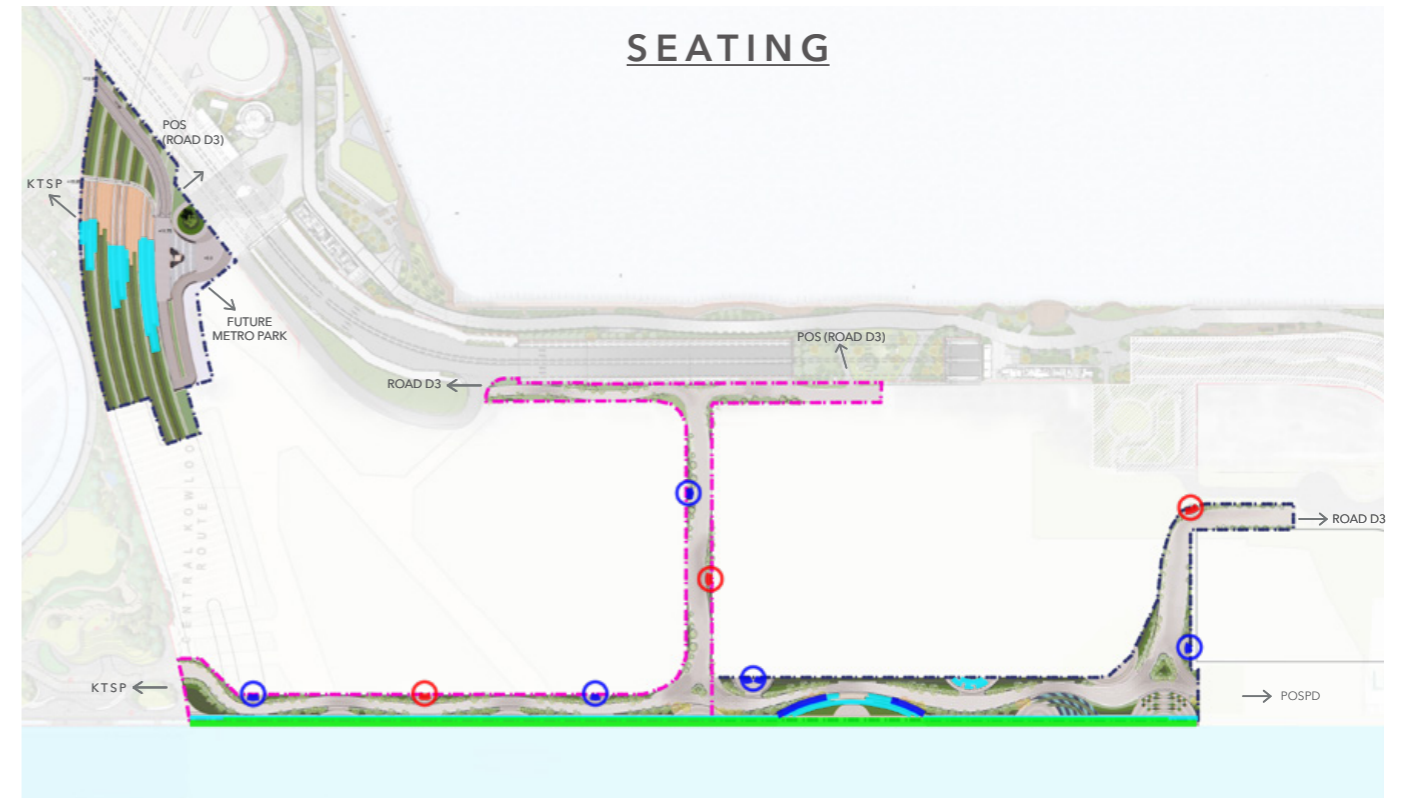

█ SHELTER SEATING █ SEATING █ SEATWALL █ HARBOUR STEP

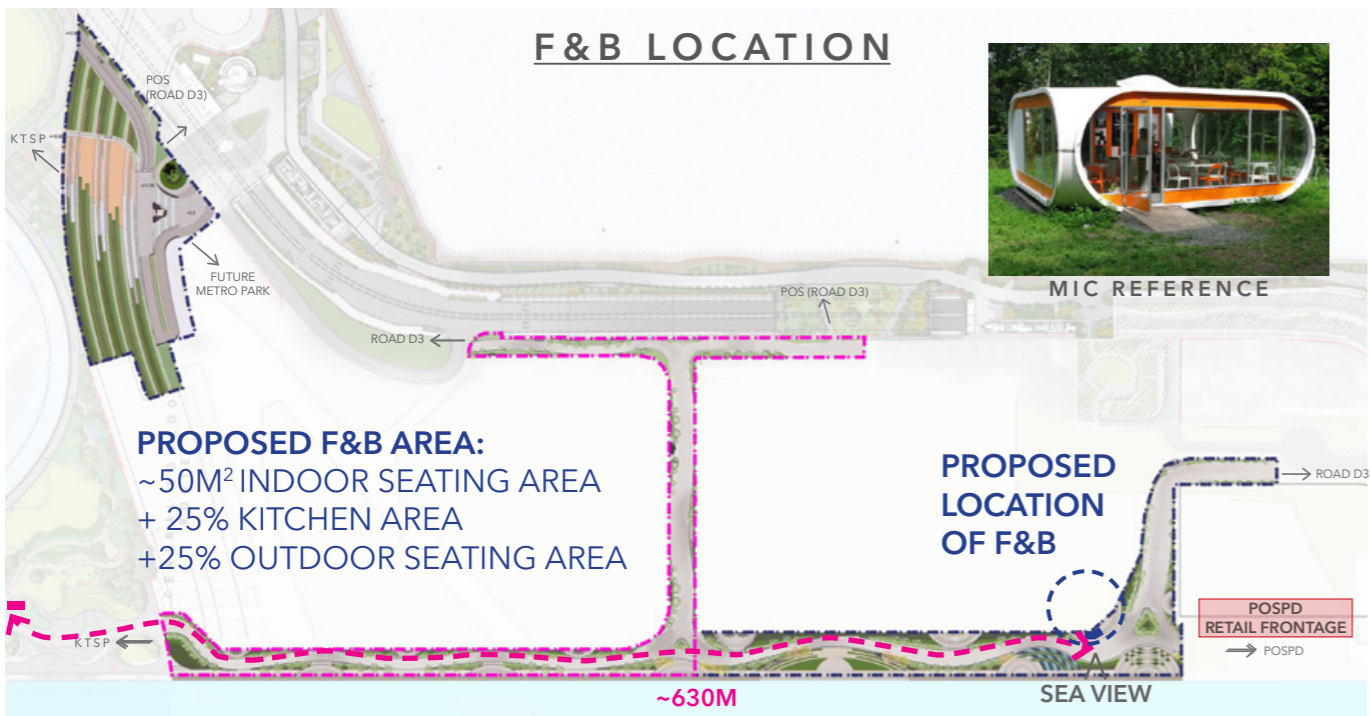

█ POTENTIAL AREA OF F&B █ F&B AREA OF ADJOINING SITES (Subject to confirmation from relevant parties) --- PATH TO F&B

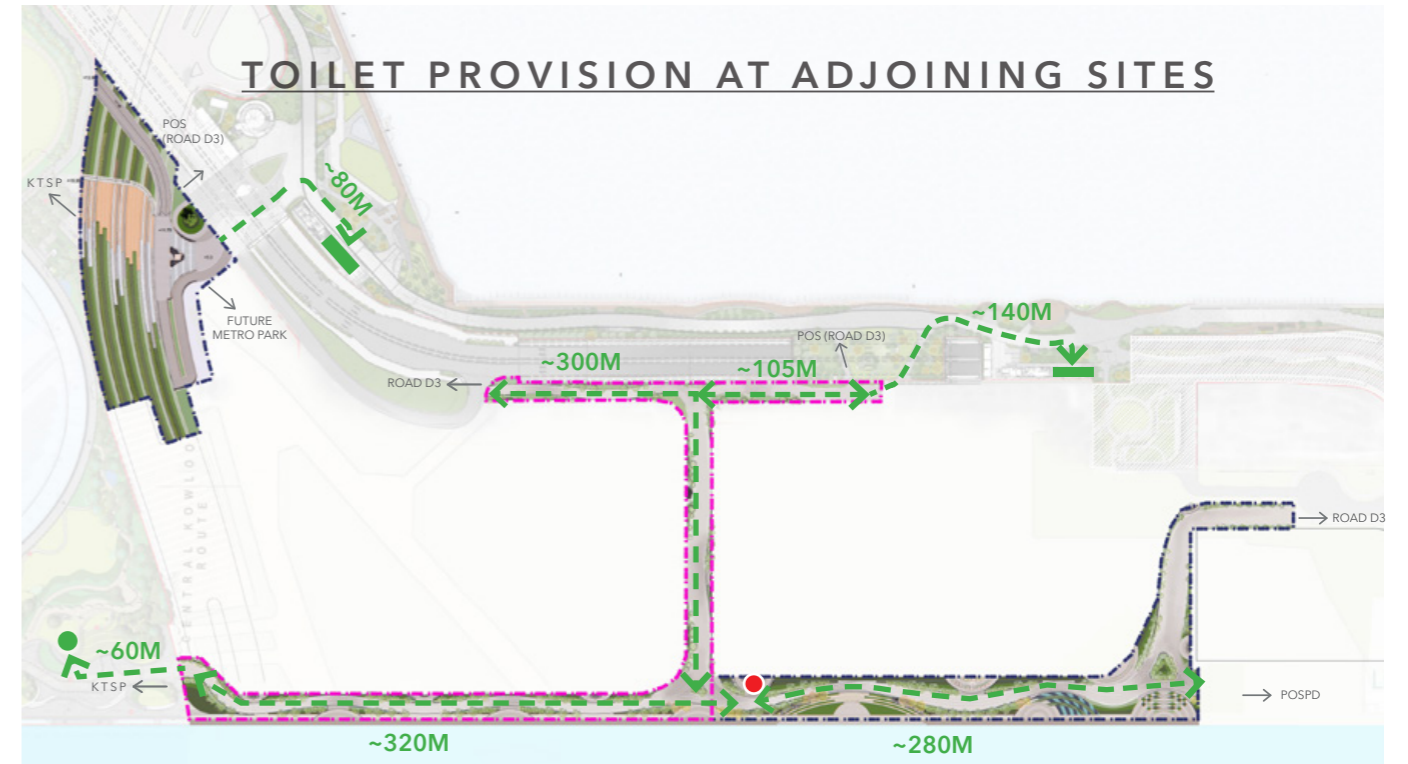

● PROPOSED TOILET LOCATION █ LOCATION WITH TOILETS (Subject to confirmation from relevant parties) --- PATH



# 5. PHASE 1 FLOWING FORMS FOR PASSIVE, TRANQUIL PROGRAMS

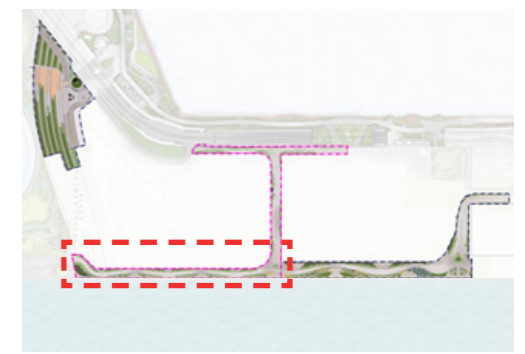
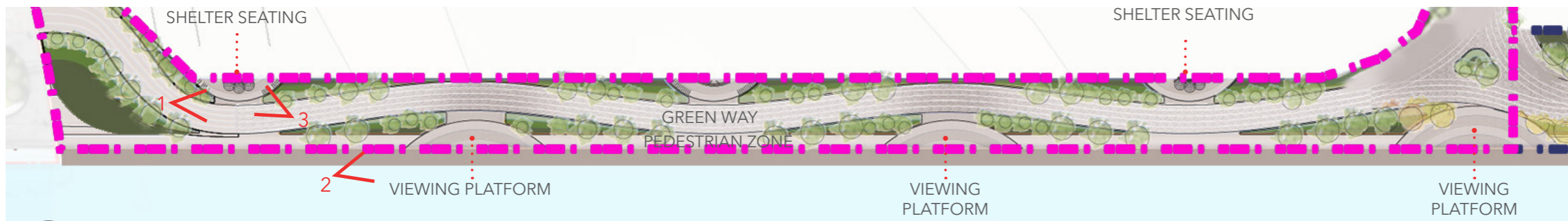

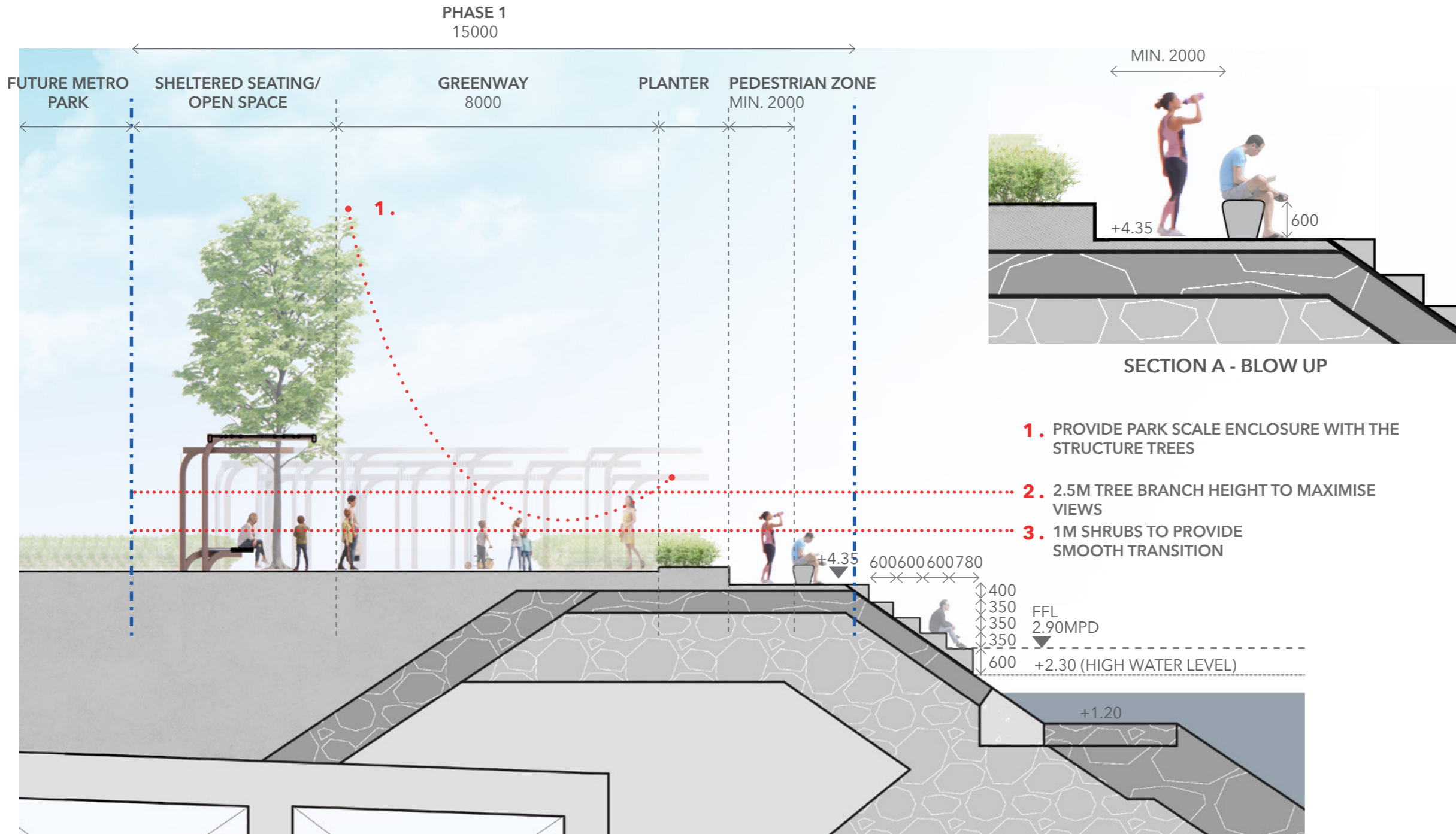

1:100 SECTION A

## 5. PHASE 1

### FLOWING FORMS FOR PASSIVE, TRANQUIL PROGRAMS

1. HARMONIOUS INTEGRATION WITH KTSP

2. SHELTER SEATING AND TREES ON BOTH SIDES OF GREENWAY PROVIDE SHADING TO MAINTAIN COOL TEMPERATURES

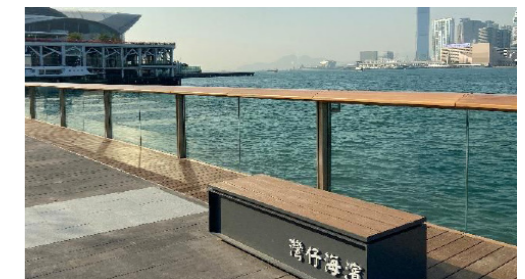

ALTERNATIVE OPTION- WITH BALUSTRADES

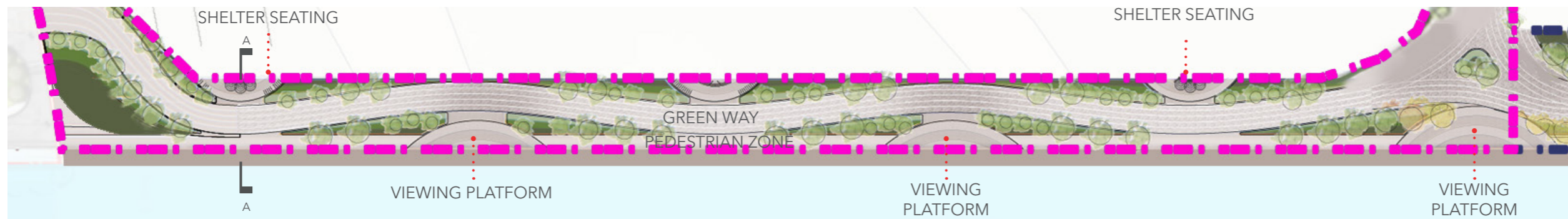

1:1000 PLAN



KEY PLAN

# 6. PHASE 2A DYNAMIC AND LIVELY FORMS AT AMPHITHEATRE FOR SOCIAL GATHERINGS

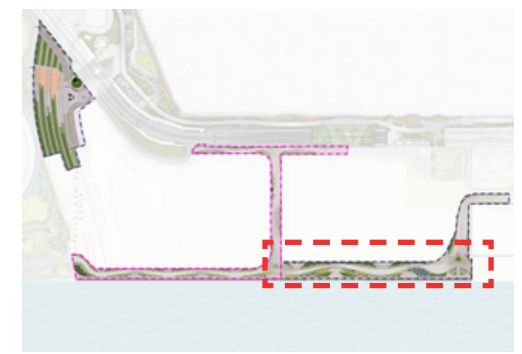
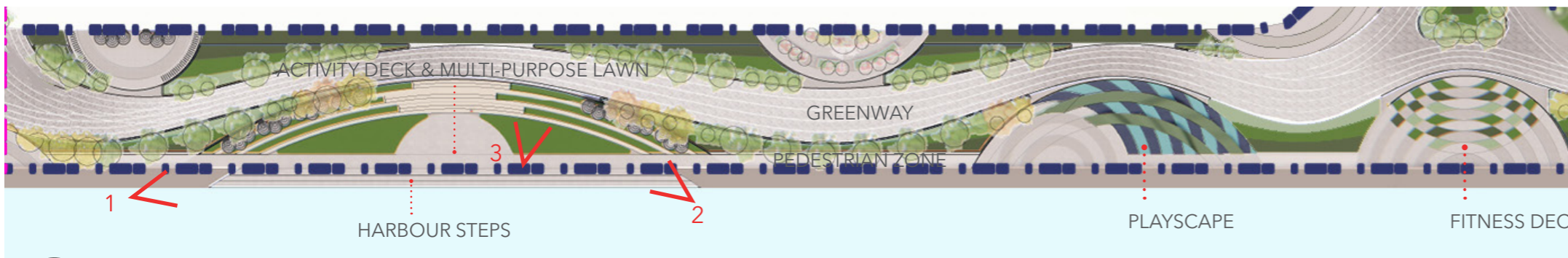

1:1000 PLAN

PHASE 2A  
25000

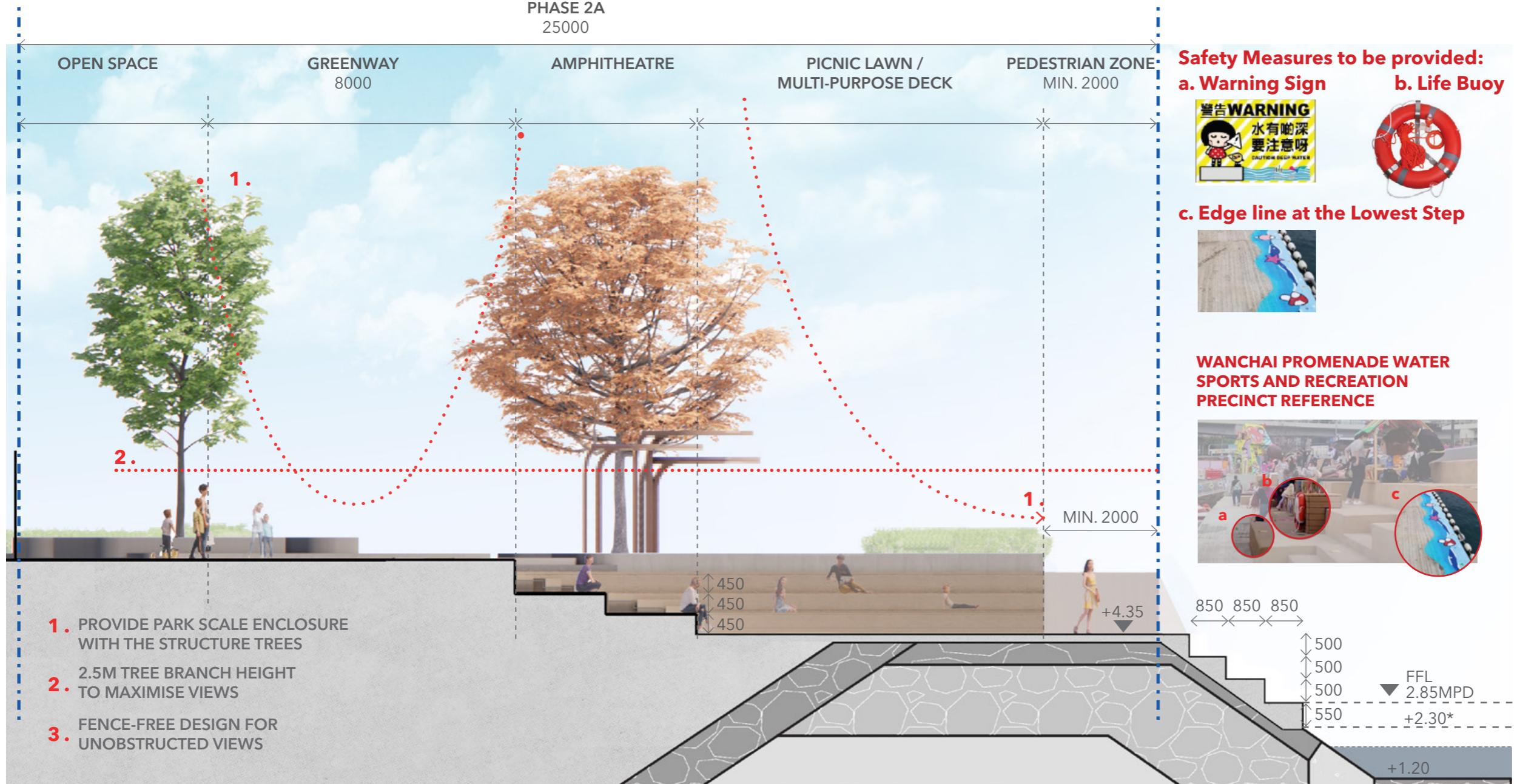

1:100 SECTION A

**Safety Measures to be provided:**  
a. Warning Sign      b. Life Buoy



c. Edge line at the Lowest Step



**WANCHAI PROMENADE WATER SPORTS AND RECREATION PRECINCT REFERENCE**



1. PROVIDE PARK SCALE ENCLOSURE WITH THE STRUCTURE TREES
2. 2.5M TREE BRANCH HEIGHT TO MAXIMISE VIEWS
3. FENCE-FREE DESIGN FOR UNOBSTRUCTED VIEWS

## 6. PHASE 2A LIVELY PROGRAMS ATTRACT USERS TO STAY

1. TREE ARRANGEMENTS  
PROVIDE **ADEQUATE SHADING** WHILE PROVIDING **UNOBSTRUCTED VIEWS** OF THE HARBOUR

2. **EYE CATCHING DESIGNS**  
BECOME PHOTOGRAPHIC HOTSPOTS



1:1000 PLAN

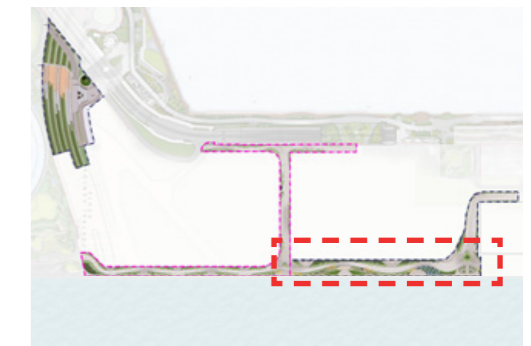

KEY PLAN



## 6. PHASE 2A PLAYScape PROVIDES FUN ACTIVITIES FOR YOUNG CHILDREN

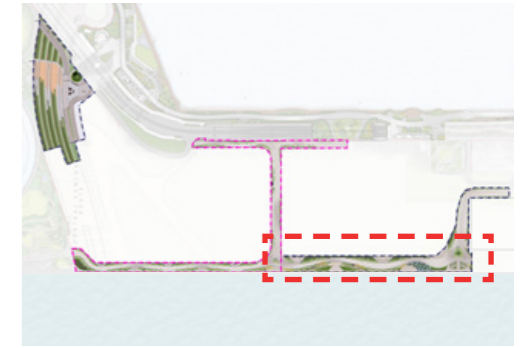

PHASE 2A  
25000

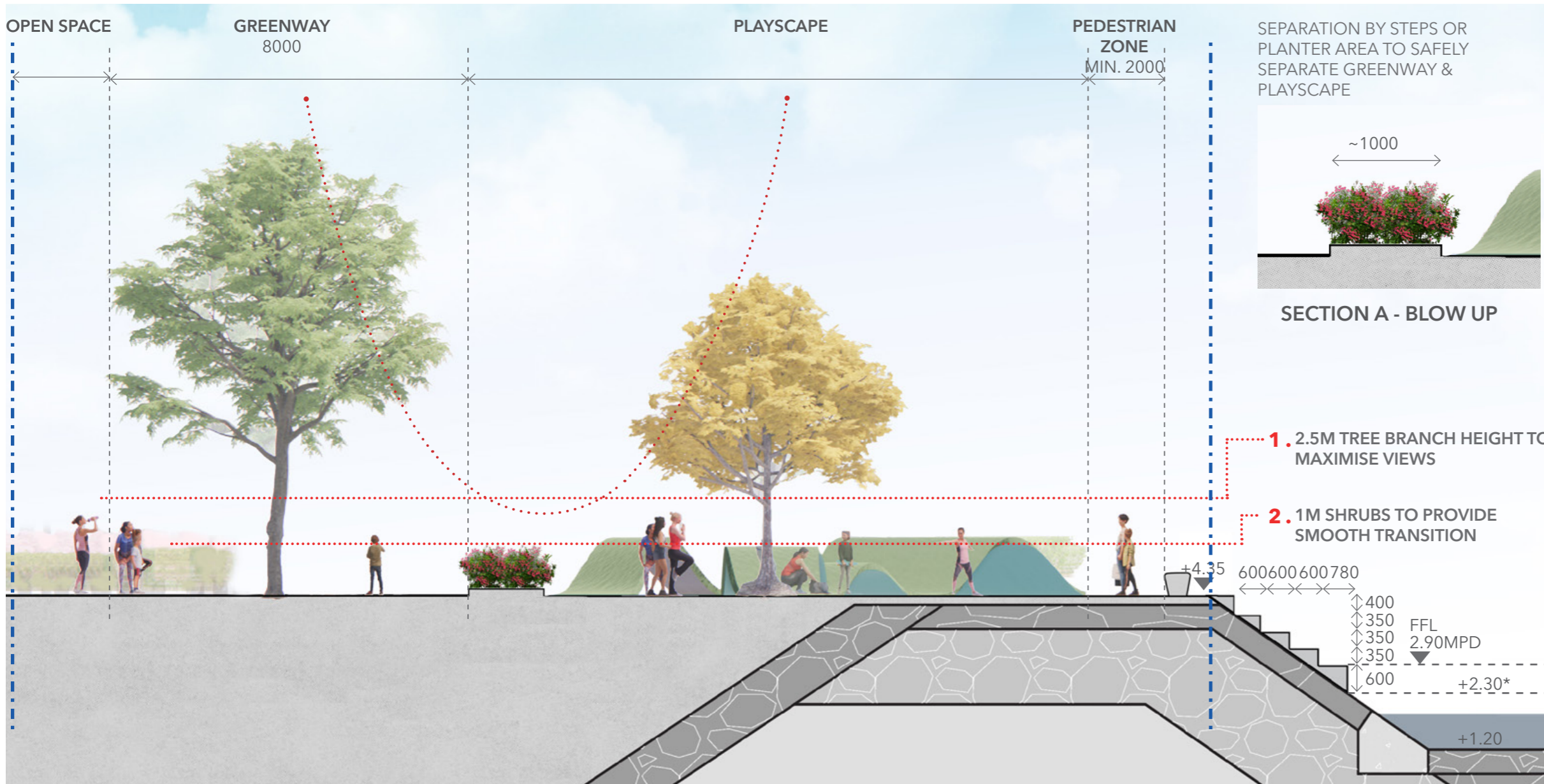

1:100 SECTION A

6. PHASE 2A

LIVELY PROGRAMS  
ATTRACT USERS TO  
STAY

1. TREE ARRANGEMENTS PROVIDE **ADEQUATE SHADING WHILE PROVIDING UNOBSTRUCTED VIEWS OF THE HARBOUR**
2. **EYE CATCHING DESIGNS** BECOME PHOTOGRAPHIC HOTSPOTS



1:1000 PLAN

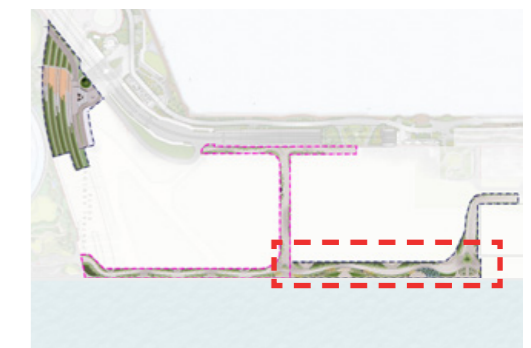

KEY PLAN



## 6. PHASE 2A VERSATILE SPACE FOR COMMUNITY EVENTS AND FITNESS SESSIONS

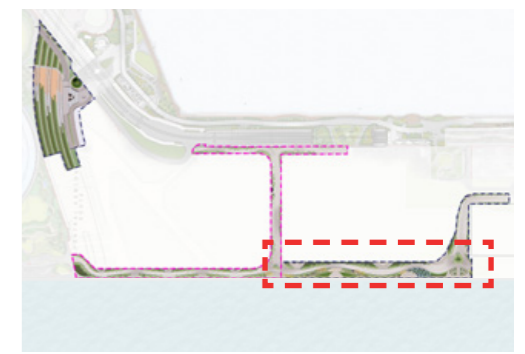
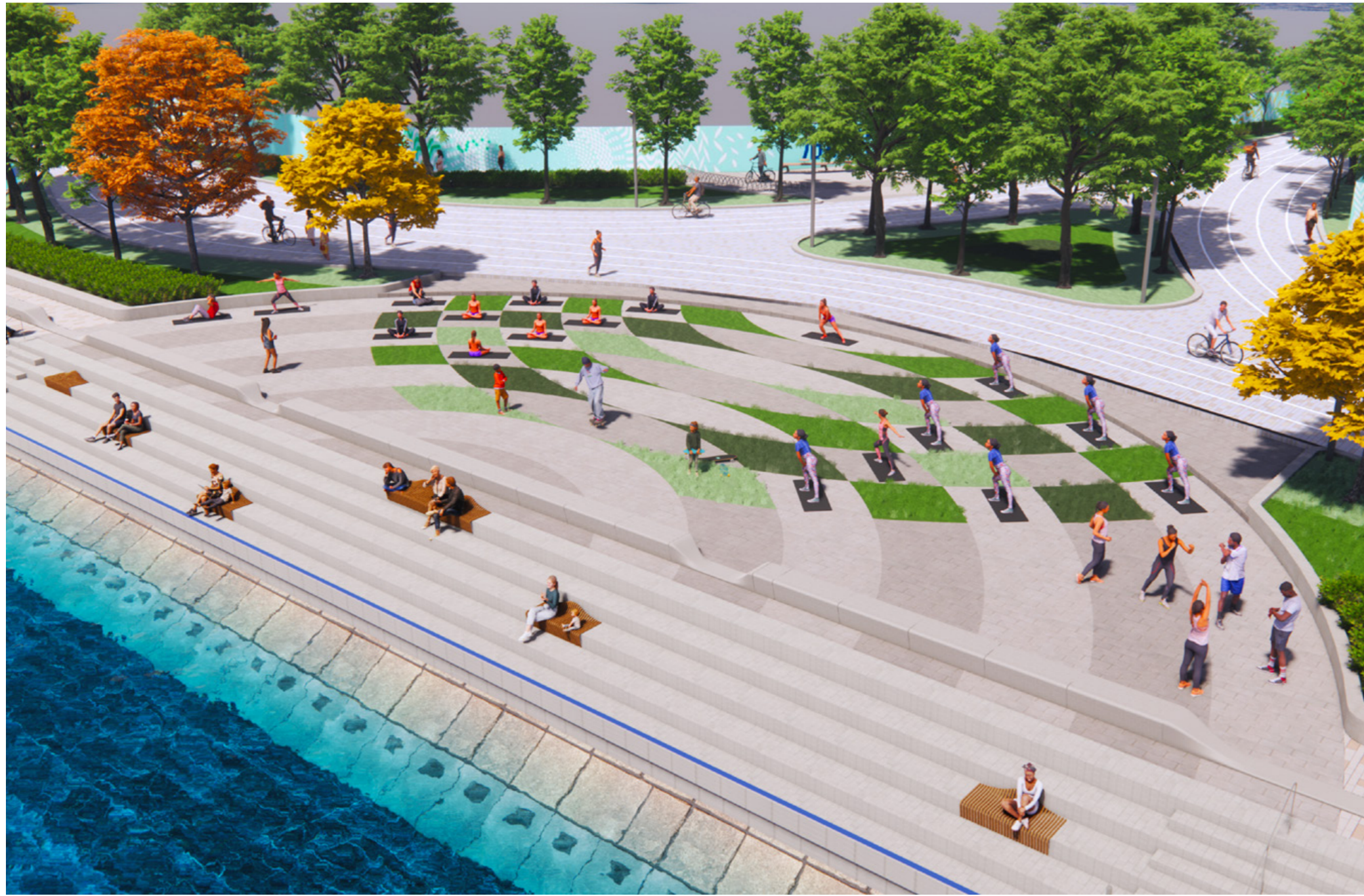

1:1000 PLAN

CLIENT  
路政署  
HIGHWAYS  
DEPARTMENT

RESIDENT ENGINEER  
ARUP M  
MOTT  
MACDONALD

CONTRACTOR  
Gammon

CONSULTANT  
ARTA  
ARCHITECTS

CONTRACT NO.  
HY/2014/07

PROJECT TITLE  
CENTRAL KOWLOON ROUTE- KAI TAK WEST  
PROPOSED PROMENADE AND LANDSCAPE DECK

# 啟德 KAITAK

活力磁場 Current of Vitality



1. USING **ICONIC KAI TAK WORD ART INSTALLATION** TO ATTRACT PUBLIC VISITS AND CREATE PHOTO-ENGAGING OPPORTUNITIES

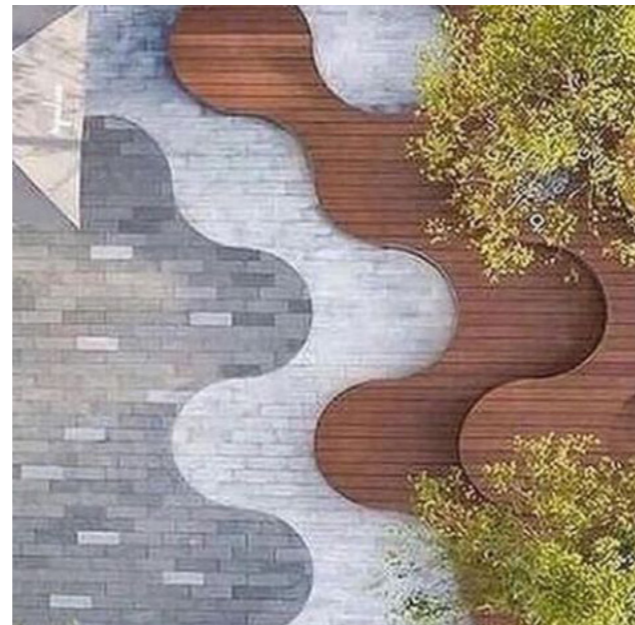

SITE LOCATED AT TREE TRUNK PORTION OF KAI TAK DNA BAR

2. USING **"TREE TRUNK" THEMED PATTERN & MATERIALS** TO CREATE A UNIQUE AND RECOGNISABLE LANDSCAPE DECK

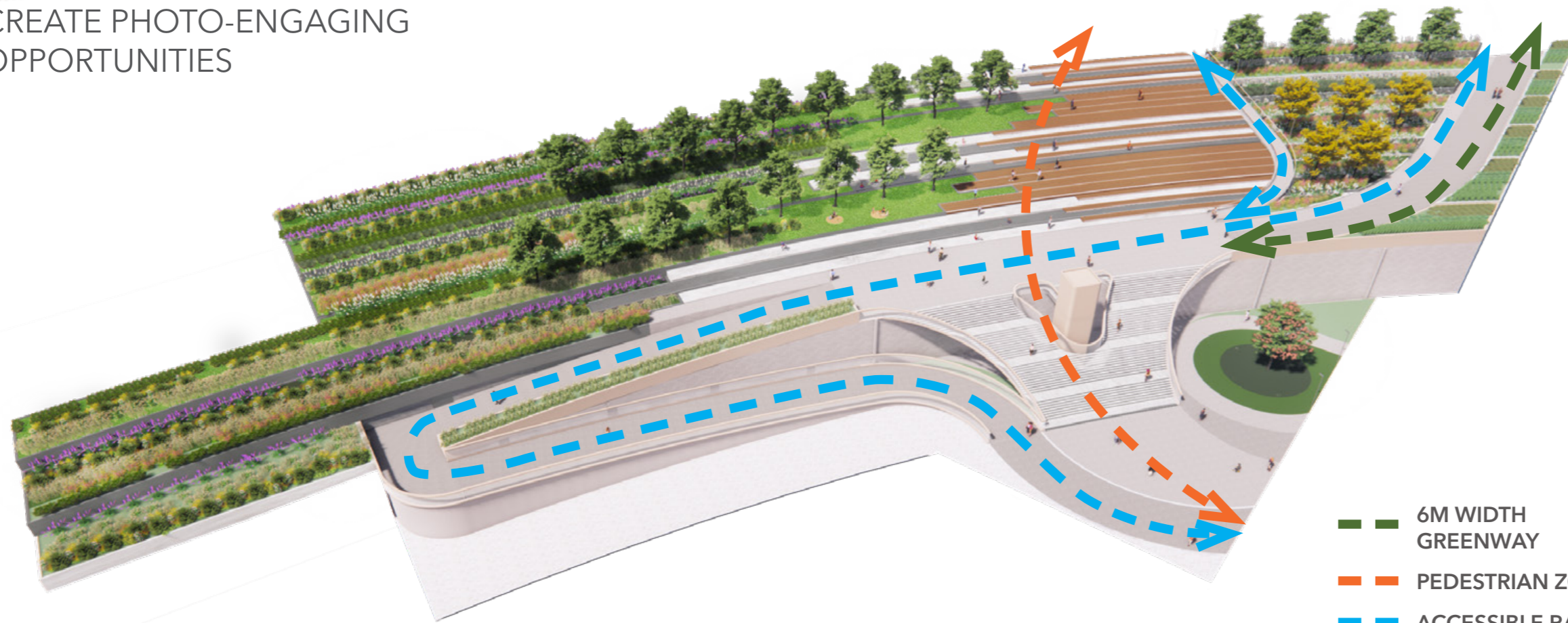

## 7. PHASE 2B ICONIC APPROACH

1. KAI TAK WORD ART INSTALLATION
2. "TREE TRUNK" THEMED PATTERN & MATERIALS

## FORM, PROPORTION, SCALE

1. **STANDARDIZED GRID SIZES** CORRELATES WITH WIDTH OF PROMENADE

2. **COHERENCE AND HARMONY** WITH ADJOINING SITES

3. PLANTING TO **SOFTEN** THE LAYOUT

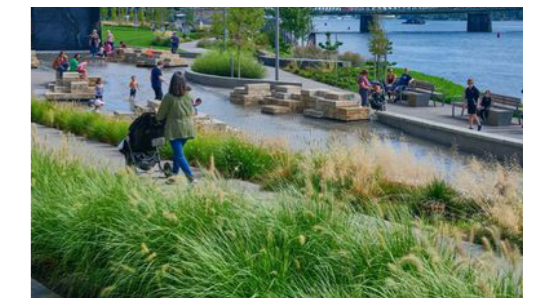
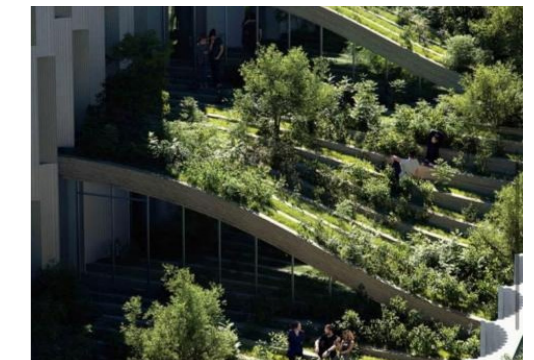



## 7. PHASE 2B SPACIOUS PLAZA WITH GRAND STAIRCASE AND LIFT CONNECTION

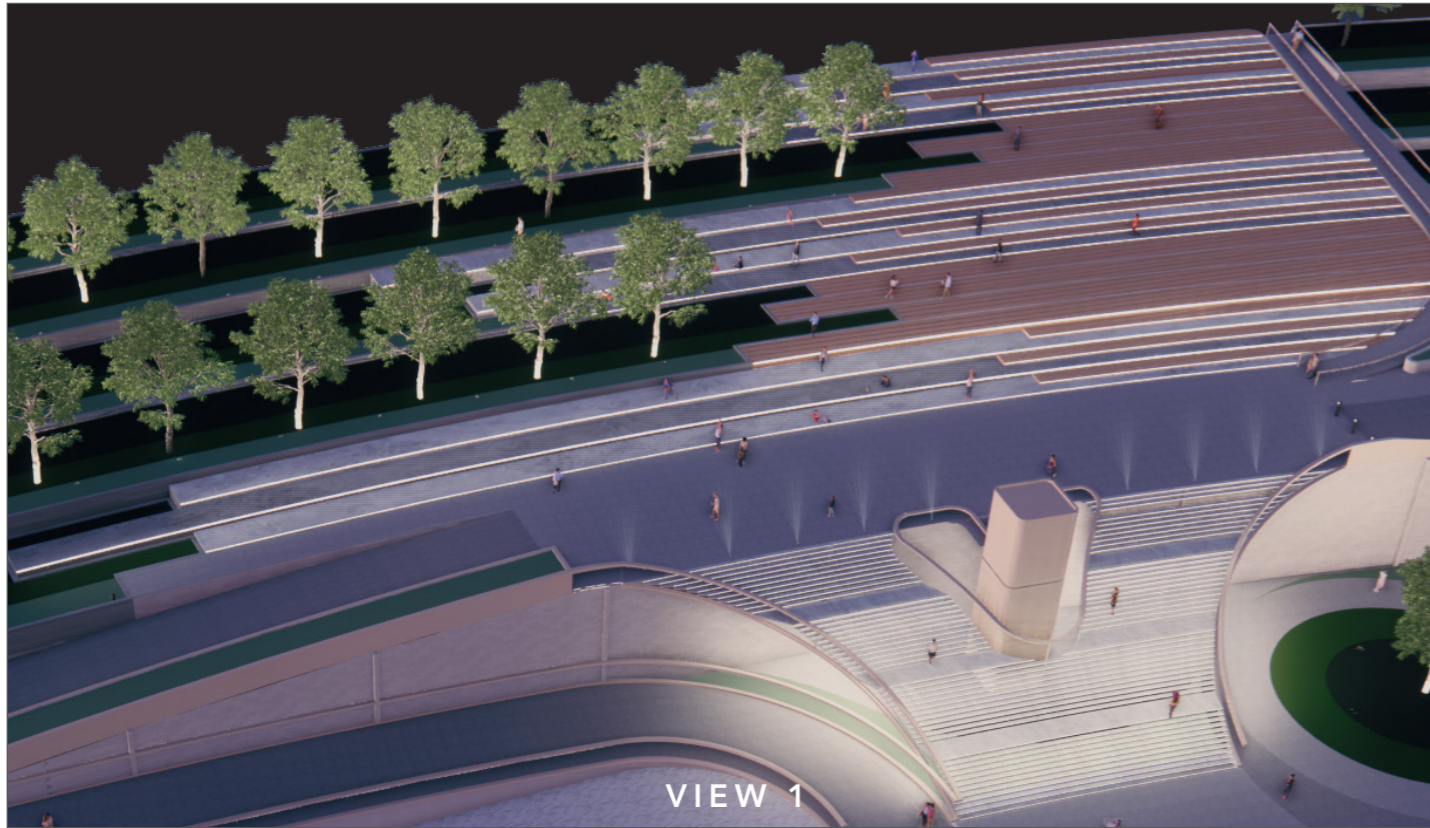

### UTILISATION OF UNDERNEATH SPACE



1. UNDER-SHADE GREENERY



2. INSTALLATION DANGLING DOWN

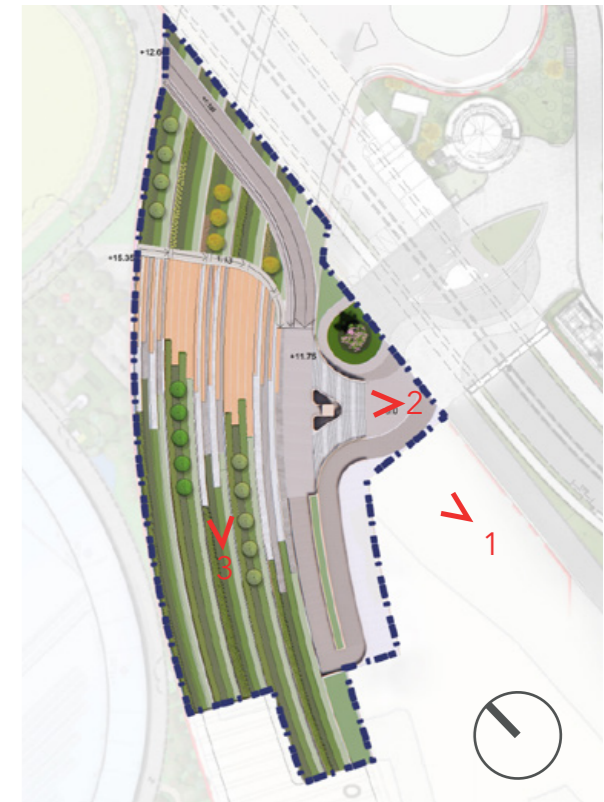

# 7. PHASE 2B STEPPED FORMS PROPORTIONAL TO HUMAN SCALE

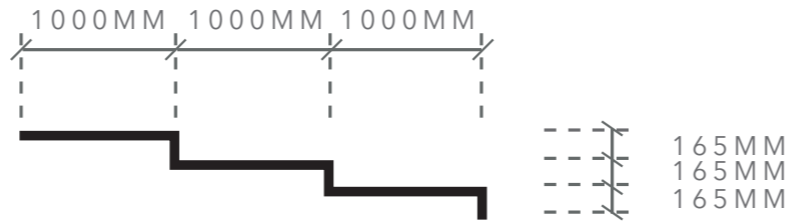
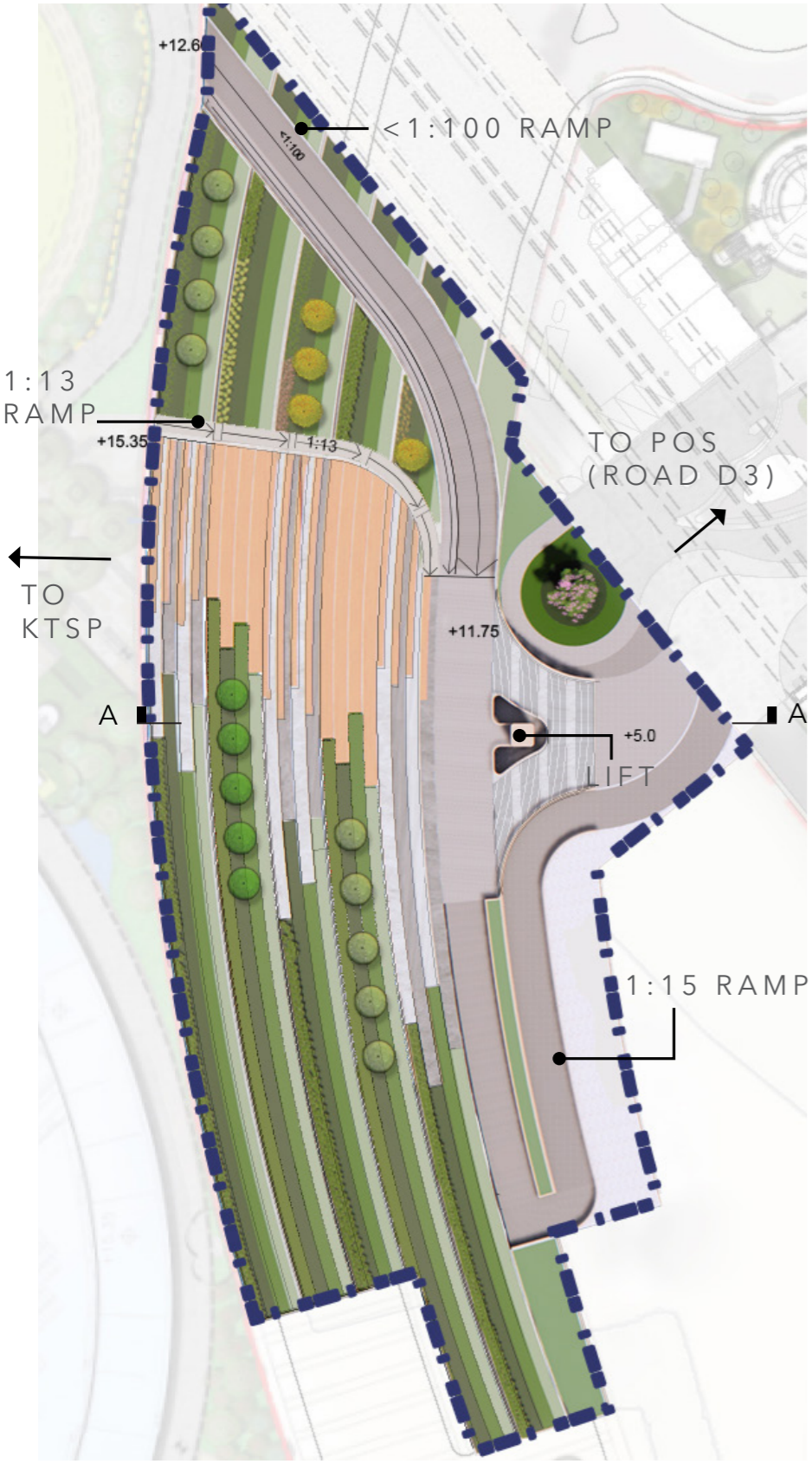

STAIRCASE SECTION

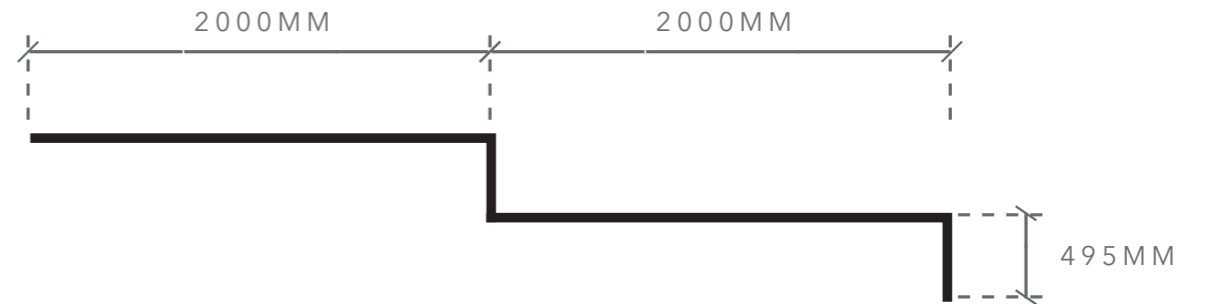

STEP SEATING SECTION

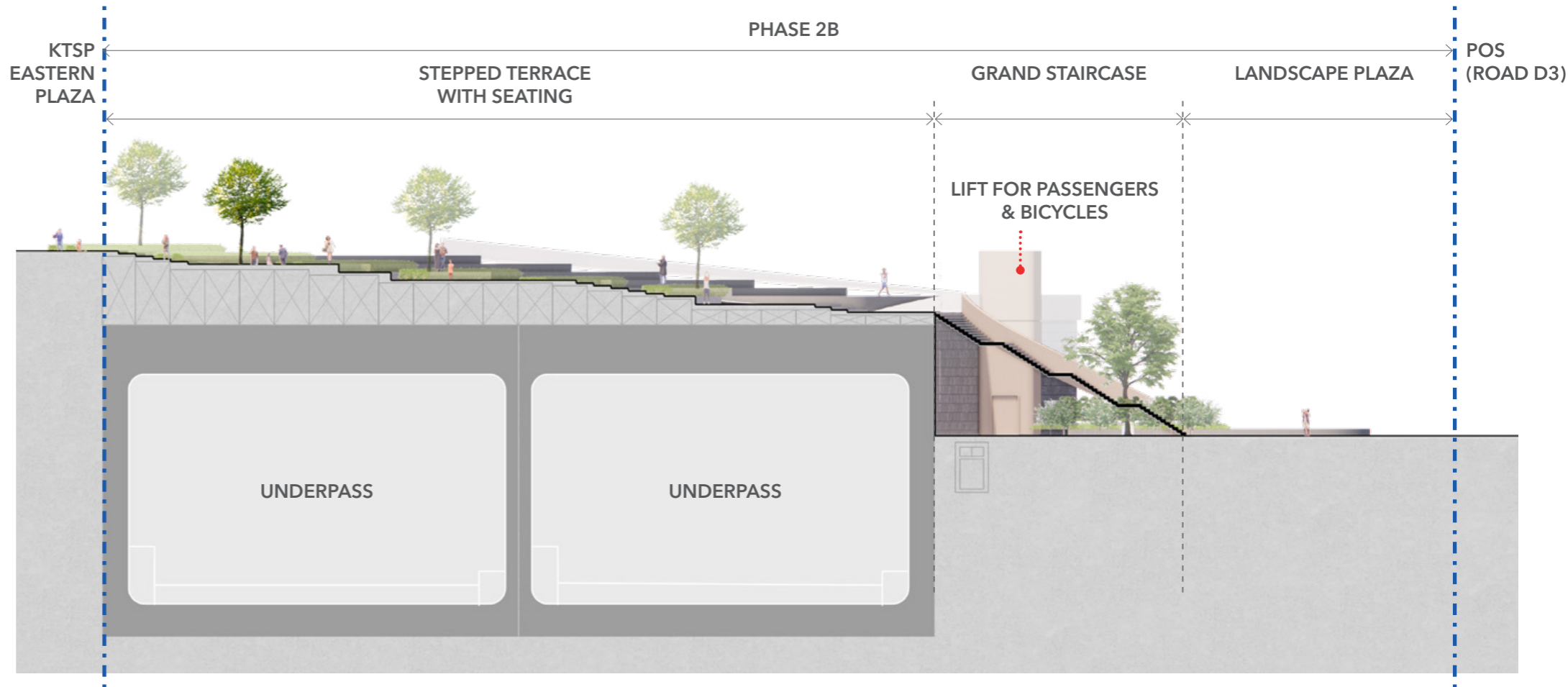

1:250 SECTION A



1:1000 PLAN



# 8. EXCITING ENVIRONMENT FOR PUBLIC ENJOYMENT AND PROPOSED LOCATIONS FOR ART INSTALLATIONS / SCULPTURES



LOCATION 1: AT THE MULTI-PURPOSE DECK

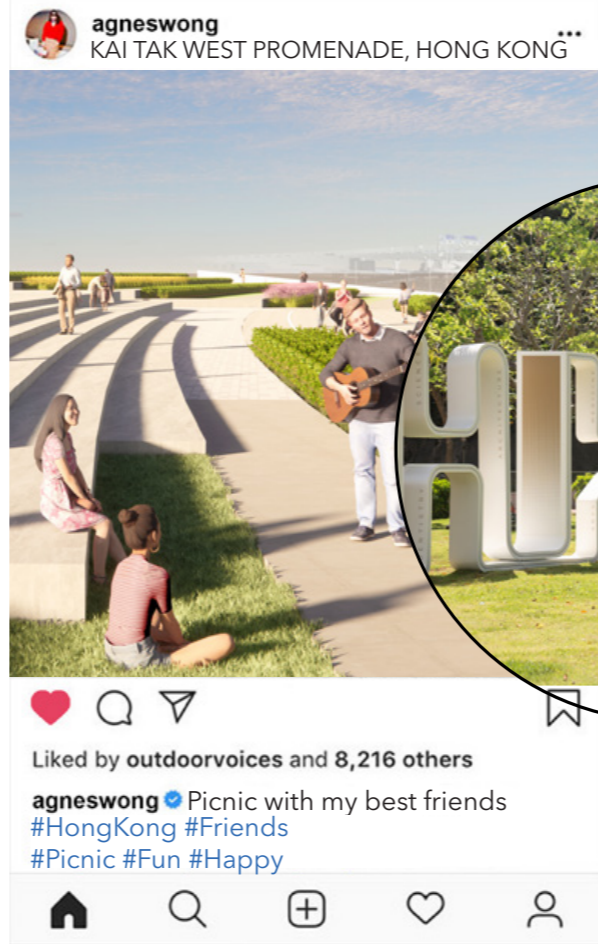

LOCATION 3: AT THE LANDSCAPE DECK



Chan Tai Man  
1hr · G  
Immersive experience at Kai Tak!!  
#lighting #art

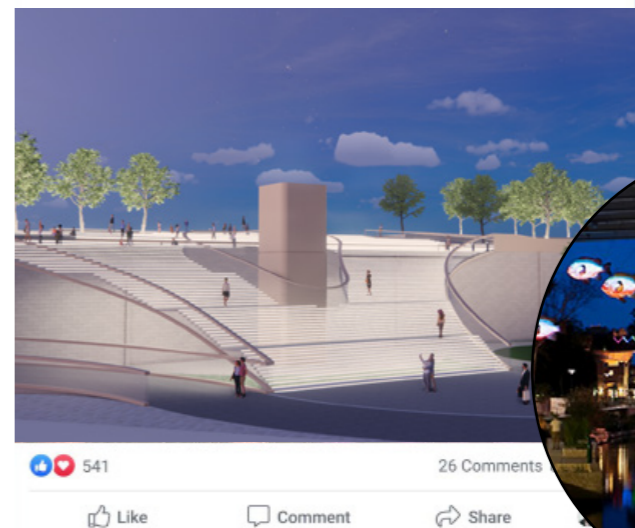

LOCATION 4: UNDER THE GRAND STAIRS

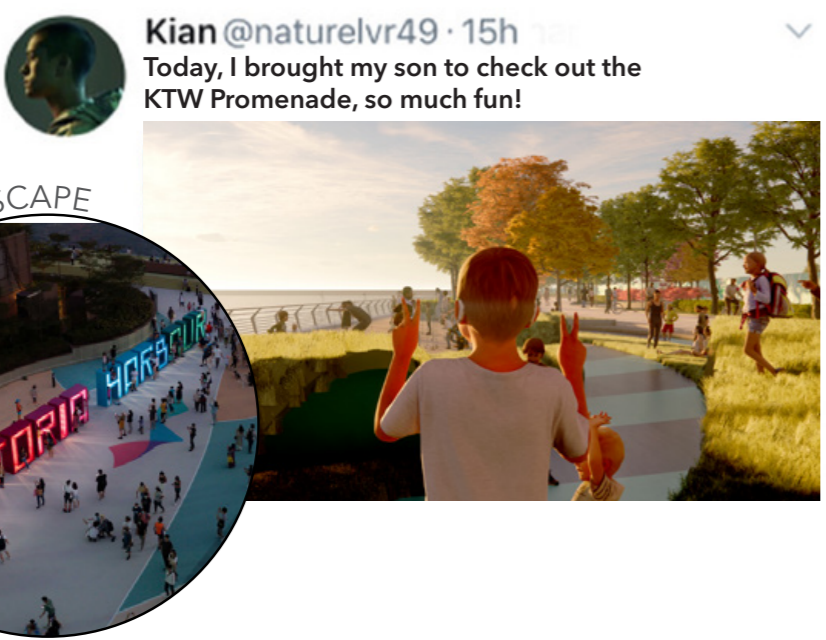

LOCATION 2: AT THE PLAYSCAPE

A VIBRANT AND PEOPLE-ORIENTED PROMENADE WITH INTERACTIVE ELEMENTS AND PHOTO-TAKING OPPORTUNITIES



#KAITAK #啟德  
#CURRENTOFVITALITY  
#活力磁場

# 9. INTERFACE WITH ADJACENT SITES

## PHASE 1 & KTSP PROMENADE



### KTSP PROMENADE GREENWAY PAVING MODULE

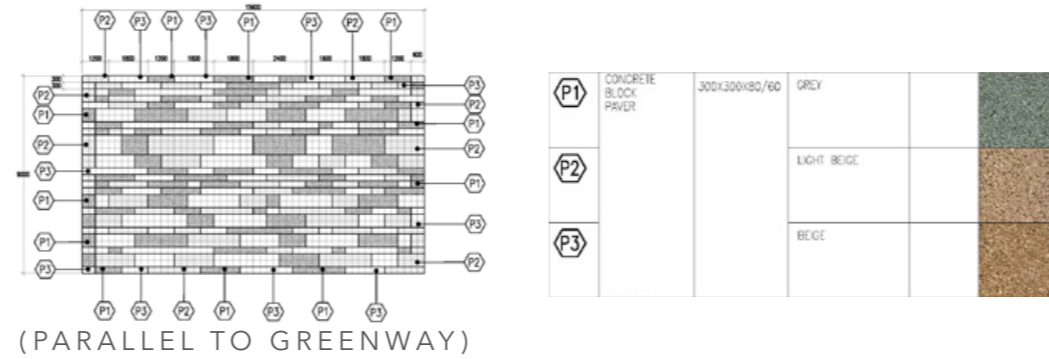

### KTSP PROMENADE PAVING MODULE

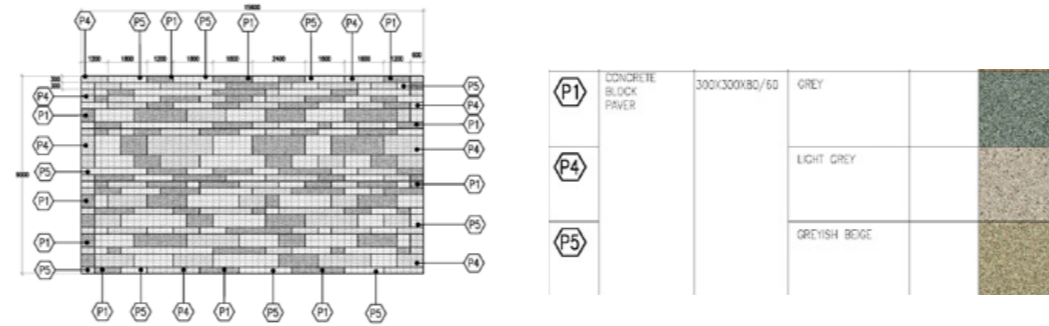

## KTW PROPOSED PAVING

### GREENWAY

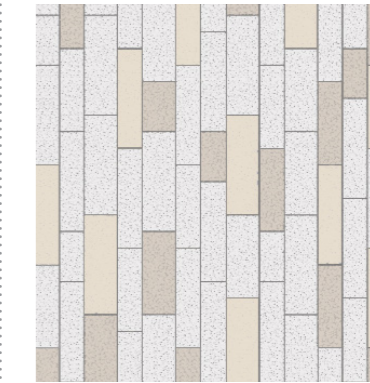

BEIGE AND GREY CONCRETE PAVER

### WATERFRONT PATHWAY

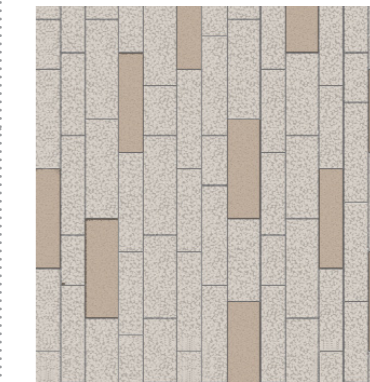

BEIGE CONCRETE PAVER

### PEDESTRIAN ZONE

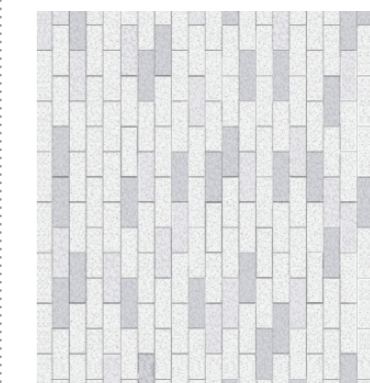

GREY NATURAL GRANITE

## PHASE 2B & KTSP EASTERN PLAZA & POS(ROAD D3)

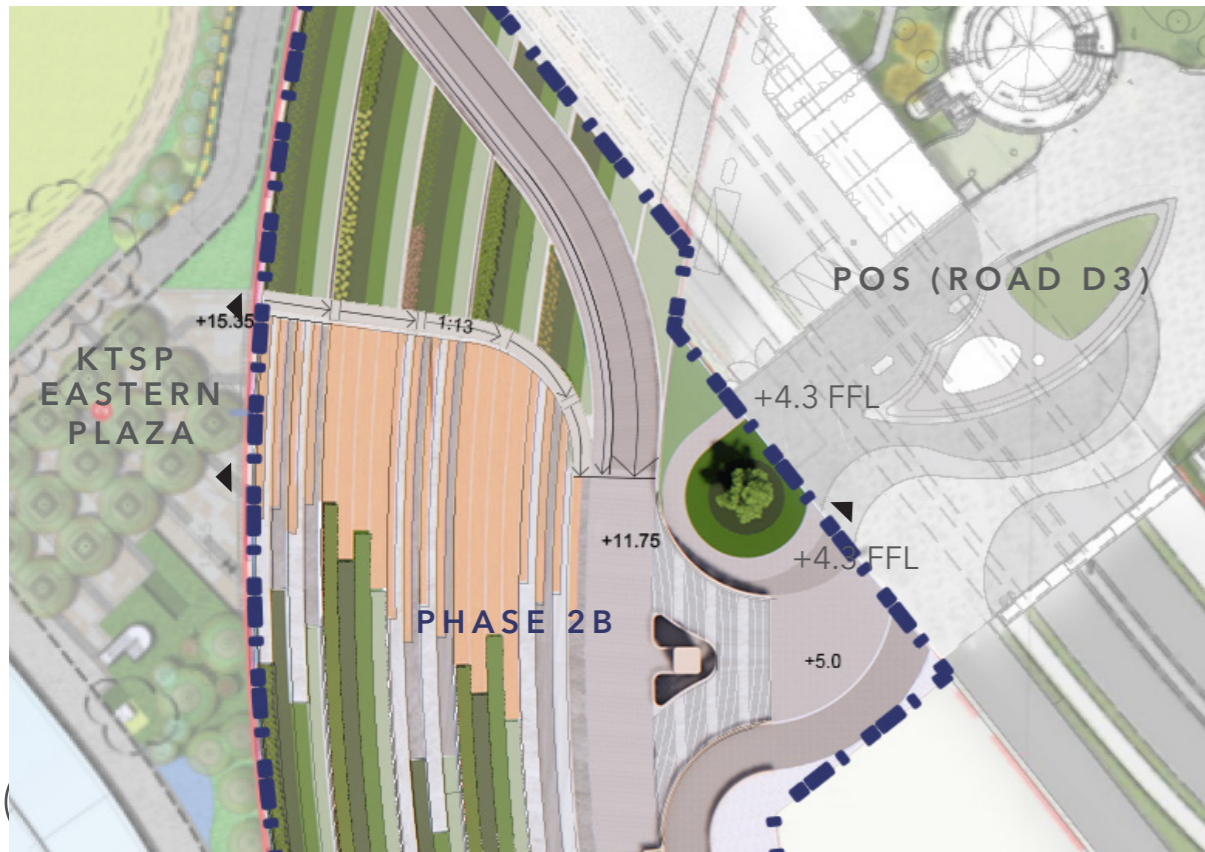

### POS (ROAD D3) PAVING MODULES

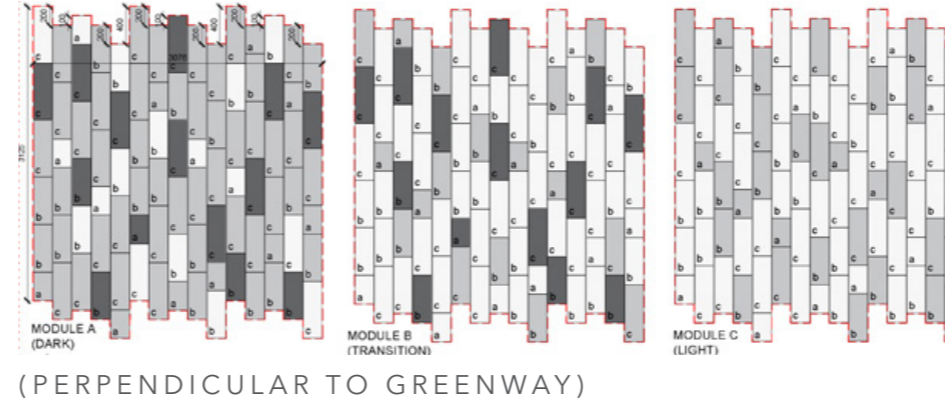

### KTSP EASTERN PLAZA PAVING MODULE

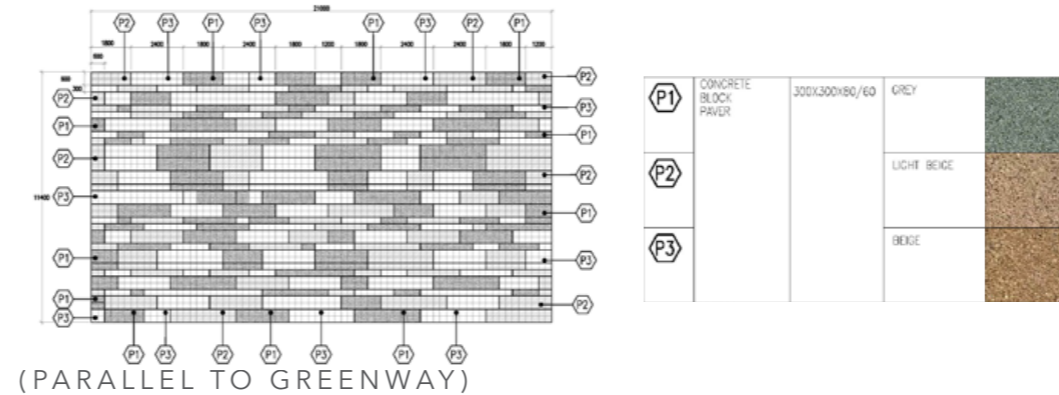

◀ POINT OF ACCESS

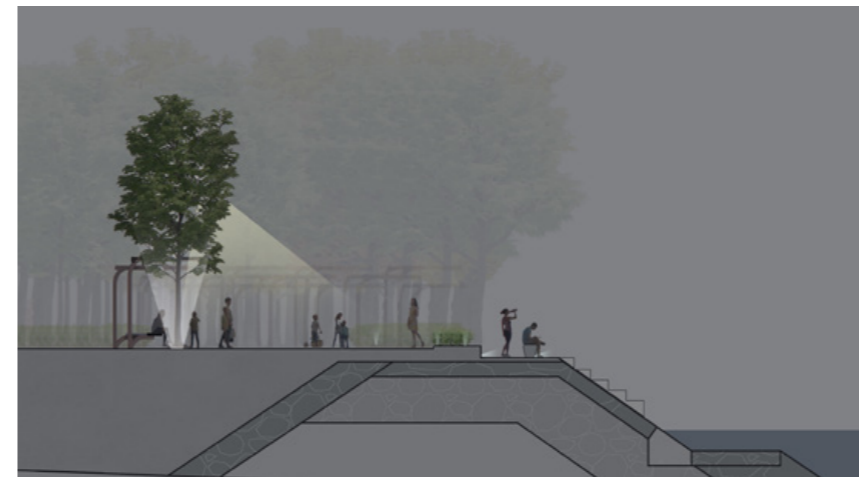

1:250 NIGHT SECTION

## 9. SUSTAINABLE DESIGN

1. **TREES TO PROVIDE SHADING** AND TO MAINTAIN COOL TEMPERATURES

2. **SOLAR POWERED LIGHTING** TO CONSERVE ENERGY

3. **RECYCLE BINS** TO ENCOURAGE RECYCLING

4. **WATER DISPENSERS** TO REDUCE USE OF PLASTIC BOTTLES

LIGHTING CONCEPT

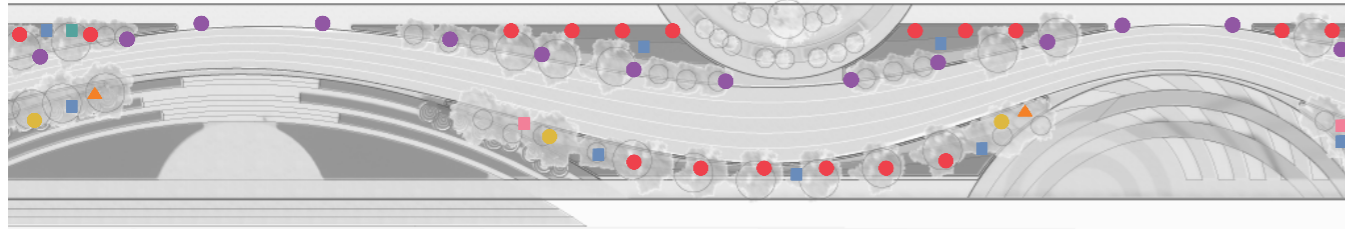

1:1000 PLAN



▲ DRINKING FOUNTAIN

■ WATER POINT



■ RUBBISH BIN



■ RECYCLE BIN



● POLE LIGHT

● LED STRIP LIGHT

● SOLAR POWER BOLLARD

● MINI BOLLARD

# 10. PLANTING STRATEGY LANDSCAPE ZONES AND THEMATIC PLANTING

## PRIMARY BOULEVARD TREES



*TERMINALIA MANTALY*  
小葉欖仁



*ELAEOCARPUS HAINANENSIS*  
水石榕

## SECONDARY BOULEVARD TREES



*CINNAMOMUM BURMANII*  
陰香



*ELAEOCARPUS DECIPIENS*  
杜英



*PONGAMIA PINNATA*  
水黃皮

## FEATURED TREES



*LAGERSTROEMIA SPECIOSA*  
大葉紫薇  
(MAY to JUL)



*CRATEVA RELIGIOSA*  
魚木  
(MAR to MAY/  
SEP to OCT)



*BRACHYCHITON ACERIFOLIUS*  
槭葉蘋婆  
(MAY to JUN)



*LIQUIDAMBAR FORMOSANA*  
楓香  
(DEC to JAN)



*SAPIUM DISCOLOUR*  
山烏柏  
(DEC to JAN)



*CASSIA JAVANICA*  
節果決明  
(APR to MAY)

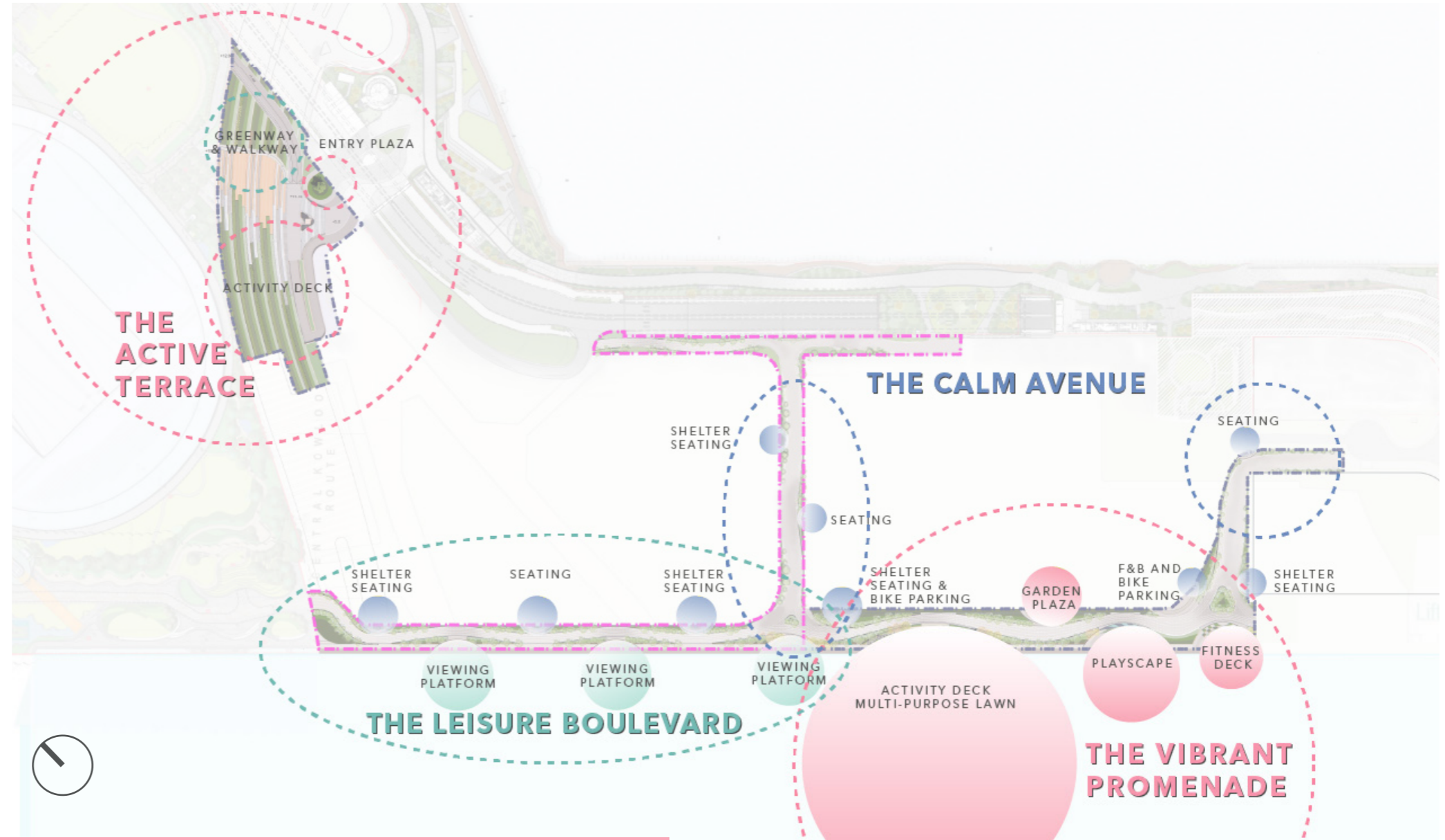

## SUMMARY

1. TREE TRUNK CONCEPT TO INTEGRATE HARMONIOUSLY WITH KAI TAK AND THE DESIGN GUIDELINES

2. EFFICIENT CIRCULATION AND PROGRAMMATIC ARRANGEMENT

3. PROPORTIONAL DESIGN RESPONDING TO SITE CONTEXT AND HUMAN SCALE

4. ADOPTION OF HARBOUR PLANNING PRINCIPLES

PRESERVING VICTORIA HARBOUR, STAKEHOLDER ENGAGEMENT, SUSTAINABLE DEVELOPMENT, INTEGRATED PLANNING, PROACTIVE HARBOUR ENHANCEMENT, VIBRANT HARBOUR, ACCESSIBLE HARBOUR, PUBLIC ENJOYMENT

5. USE OF MODULAR AND STANDARDIZED DESIGNS FOR EASY CONSTRUCTION AND COST CONTROL

6. PROVEN TRACK RECORD OF DESIGN AND CONSTRUCTED WORKS ALONG HARBOURFRONT IN SHORT TIME FRAME ATTRACTING A LOT OF USERS AND EXCITEMENT ON SOCIAL MEDIA

